

LOCATION MAP



CREDITS

ARCHITECT
Unusual Spaces

RCC CONSULTANT
Hansal Parikh & Associates

ADVOCATE
V.P. Kadekar

BRAND & MEDIA
Silk Route



Sr. No.226/27, Behind Ambiance Hotel, Annapurna Hotel Lane, Kaspate Wasti, Wakad Pune-411057
Ph.: +91 20 64107589, Mob.:+91 9028028899/ 9225512069
Email: sales@vardhamandreams.com | www.vardhamandreams.com

Disclaimer: "All the specifications, plans, images, designs, facilities, dimensions and other details mentioned herein are only indicative and artist's impression and not to scale and/or specifications. Right to change any of these is reserved in the interest of the development without any notice and/or if any concerned authority/insist for any change, during the course of approvals. This material does not constitute an offer or contract. Any purchaser/ investor shall be governed only by the terms and conditions of the Agreement to be entered into between the parties. Construction shall be subject to the change in or variation of the terms and conditions imposed by concerned authorities. Details mentioned in this material shall not govern such transactions and the images herein are for presentation purpose only".





THE FUTURE LIES IN YOUR DREAMS

A dream doesn't become reality through magic; it takes sweat, determination and hard work. Keeping this authentic thought in mind, 'Vardhaman Dreams' has been crafted with precision. 2, 2.5 and 3 BHK luxury residential apartments thoughtfully located in the voguish zones of Wakad. Avant-grade amenities, superior quality construction, pioneering architecture and spaces that serve you a complete privacy are some prominent offerings to you by Vardhaman Group. The project also features close proximity to famous IT sectors, educational institutes, entertainment hubs, hospitals and everything which you will need in your day to day life. Vardhaman Dreams encircle you with the absolute happiness.



*An Artist Impression

BE THE REAL DREAMER!

The dream is a beginning for an ambition and a strength for a positive approach and is the place where we store a true part of our soul, away from the rest of the world. At 'Vardhaman Dreams', you can cherish the truth with the world. Where happiness truly lies in your dreams and we are geared up to fulfil your pleasure. Lifestyle at Vardhaman is a manifestation of your up to date living. With the classy amenities and tasteful vicinity, you can take pleasure in your divine expectations. Every single piece at Vardhaman has been crafted with you in mind. For us, your happiness and joy lies in our honest creation and we are here to gratify all your belief.



*An Artist Impression



*An Artist Impression



*An Artist Impression



*An Artist Impression



EVERY GREAT DREAM BEGINS WITH A DREAMER!

With the excellent facilities like club house, gymnasium, multipurpose hall, senior citizen sit-outs will satisfy all the generations of your family and some attractive features like children's play area, party lawn, jogging track, an activity wall, a gazebo, amphitheatre, skating rink, multipurpose sports court will make your child a Rockstar and a curious little one.





*An Artist Impression



Identical 2 BHK Perspective View



Identical 2.5 BHK Perspective View



Identical 3 BHK Perspective View

AMENITIES

CLUB HOUSE

- Party Lawn
- Gymnasium
- Multi Purpose Community Hall
- Indoor Games
 - Table Tennis
 - Carrom Board
 - Chess Corner

CHILDREN'S RECREATION

- Children's Play Area
- Skating Rink
- Sand-pit
- Open Amphitheatre

OUTDOOR SPORTS

- Multi Utility Court
- Practice Basket Ball Court
- Exercise Zone
- Jogging Track / Walkway
- Acupressure Path

LANDSCAPE GARDEN

- Community Garden
- Senior Citizen Sit Outs
- Stage
- Gazebo / Pavilion
- Trellis

AUTOMATION

- Provision For Wi-fi
- Provision For Broadband
- Power Backup For Common Utilities / Areas
- Provision For Inverter Point
- Automatic Hi-speed Elevator

SAFETY & SECURITY

- Designer Entrance Lobby
- CCTV Surveillance System
- Intercom Facility
- Video Door Phone
- Boom Barrier On Entrance Gate
- Security Cabin

GREEN FEATURES

- Garbage Chute
- Rain Water Harvesting
- Fire Fighting System
- Solar System In 1 Washroom

SPECIFICATION

STRUCTURE:

- Earthquake Resistant RCC Structure
- Aesthetically Designed Elevation

WALL FINISH:

Masonry:

- 6" Thick AAC Internal & External Walls
- Internal Walls With POP/ Gypsum Finish
- Sand Faced Plaster Externally

Paint:

- Internally Acrylic Emulsion Paint
- Externally Weather Shield Acrylic Paint

Tiles:

- Designer Dado Tiles In The Washroom, Toilets & Above Kitchen Platform

FLOORING:

Living Room, Bedroom & Kitchen:

- 2'X2' Vitrified Tiles

Washroom, Toilet & Terrace:

- Branded Antiskid Floor Tiles

DOORS:

Entrance Door:

- Elegant Designer Laminated Flush Door
- Brass Finish Branded Accessories & Fixtures

Bedroom:

- Both Side Laminated Flush Door

Toilets:

- Granite Frame With Both Sides Laminated Waterproof Flush Door

Terrace:

- Powder Coated M.S. Folding Door
- Stainless Steel Railing With Toughened Glass

WINDOWS:

- 3 Track Powder Coated Aluminium Sliding
- Insect Mesh
- M.S. Safety Grill & Granite Frame

SEMI – FURNISHED KITCHEN:

- Granite Platform With Branded Stainless Steel Sink
- Attached Dry Balcony
- Provision For Water Purifier

ELECTRICAL:

- Concealed Fire Retardant Low Smoke Copper Wires
- Circuit Breaker
- Cable, T.V. & Telephone Point In Living & Bedroom
- Premium Quality Modular Switches
- Split A.C. Provision In Bedroom
- Fridge, Oven & Food Processor Point In Kitchen
- Provision For Exhaust Fan In Kitchen & Washrooms
- Provision For Washing Machine Point In Dry Balcony

PLUMBING:

- Concealed Piping
- Premium Quality Sanitary & Bath Fittings
- Premium Range Branded C.P. Fittings
- Provision For Geyser In Bedroom
- Provision For Water Purifier In Kitchen
- Hot & Cold Mixers In On Wall Washrooms

WING: A

Typical 1st, 3rd, 5th & 7th Floor Plan



WING: A

Typical 2nd, 4th, 6th & 8th Floor Plan



WING: B

Typical 1st, 3rd, 5th & 7th Floor Plan

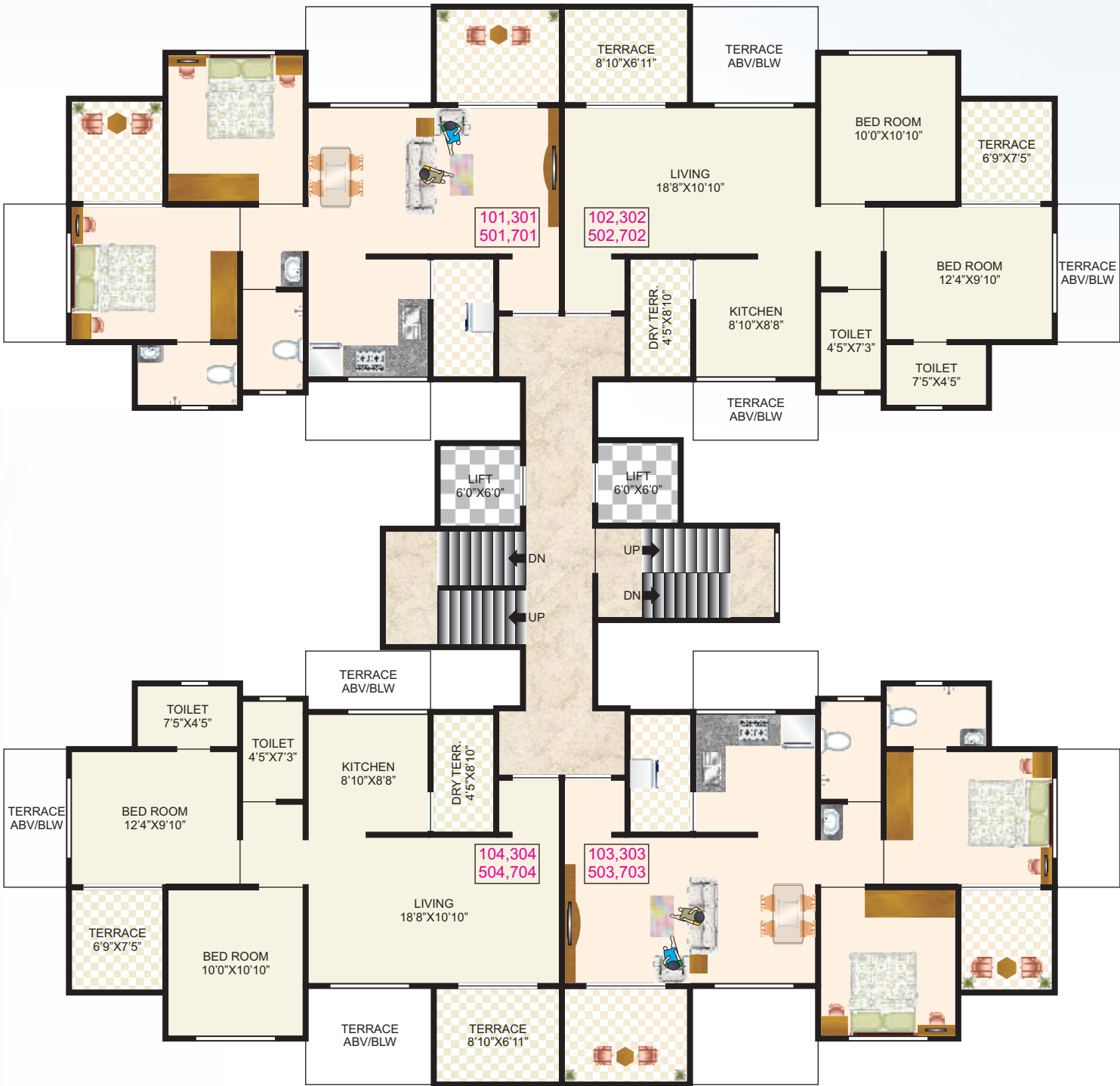

WING: B

Typical 2nd, 4th, 6th & 8th Floor Plan

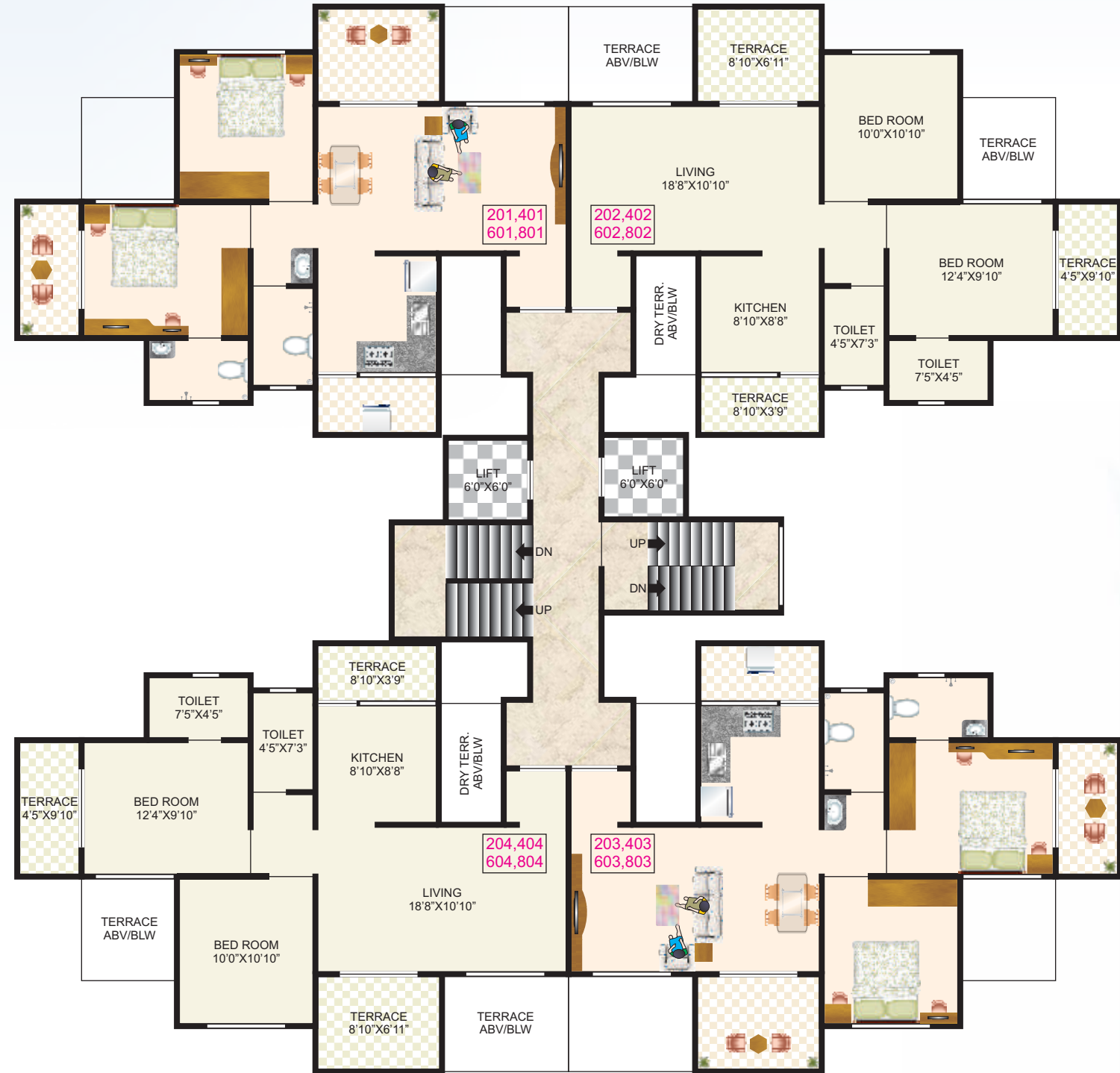

Typical 1st, 3rd, 5th & 7th Floor Plan



Typical 2nd, 4th, 6th & 8th Floor Plan



WING: D

Typical 1st, 3rd, 5th & 7th Floor Plan



WING: D

Typical 2nd, 4th, 6th & 8th Floor Plan



WING: E

Typical 1st, 3rd,
5th & 7th Floor Plan



WING: E

Typical 2nd, 4th,
6th & 8th Floor Plan

